



MBMOD

MODULAR GLOVEBOXES

PICTURE SHOWS PRODUCT WITH OPTIONS



- Modular design
- Expandable
- Various box sizes
- Stainless steel construction
- Integrated high vacuum feedthroughs
- Conform to CE



Technical Data

General Data

Product: Modular Glovebox System **MB MOD**
Type: Modular Glovebox
Size: Various sizes available, see page 4

Glovebox

Type

Modular glovebox with bolted side panels
Material: Stainless Steel 1.4301 (US type 304) thickness 3 mm
Inside surface: Brushed finish $R_a < 1 \mu\text{m}$ (DIN ISO 1302)
Outside surface: Coated, grey, RAL 7035

Feedthroughs

DN 40 KF: 4 pieces for customers usage (e.g. electrical feedthrough)
Electrical feedthrough: KF40 included (100, 110 or 230 V)

Dust Filter

MB-BF-L-03[®] 0.3 μm , class H 13, 1 gas inlet filter / 1 gas outlet filter

Shelves

3 shelves: Stainless Steel 1.4301 (US type 304), height adjustable, for 780mm depth glovebox
2 shelves: Stainless Steel 1.4301 (US type 304), hanging from box ceiling, for 1000/1200mm depth gloveboxes

Box Windows

Inclined panel: Lexan thickness 10 mm*
 *safety glass on request

Glove Ports

Type: POM (Polyoxymethylen) 220 mm dia., O-ring sealed

Gloves

Material: Butyl, thickness 0.4 mm*
 *other sizes and materials on request

Box Light

Fluorescent lamp: Front mounted

Glovebox

Leak Rate According to ISO 10648-2 (Oxygen Method)

< 0.05 vol%/h typical (Class 1, measured at final acceptance test)

Leak Rate According to ISO 25412 (Press. Change Method)

< 0.05 vol%/h at negative pressure of 10 mbar at constant temp. (measured at final acceptance test)

Antechamber (Option)

Type

Cylindric type antechamber* 390 mm dia., length 600 mm (inside dimensions)
Material: Stainless Steel 1.4301 (US type 304), thickness 2.5 mm
Inside surface: Brushed finish
Outside surface: Coated, grey, RAL 7035
 *rectangular on request

Sliding Tray

Material: Stainless steel 1.4301 (US type 304)

Doors

Material: Aluminum (AlMg3), anodized, thickness 10 mm
Door lock: Easy to operate spindle-lock with lifting mechanism

Pressure Gauge

Manometer: Analog display
Optional: Pirani gauge (when using automatic antechamber control)

Leak Rate

< 10^{-5} mbar l/s

Expandability

Optional Features

The system can be extended with MBRAUN extension components optionally available

For example: mini antechamber, H₂O/O₂-analyzer, refrigerator, solvent absorber, microscope equipment, automatic antechamber control incl. mechanical door locks, gas purification system

MBMOD

Dimensions

The MB MOD system is available in the following dimensions: inside dimensions (mm)

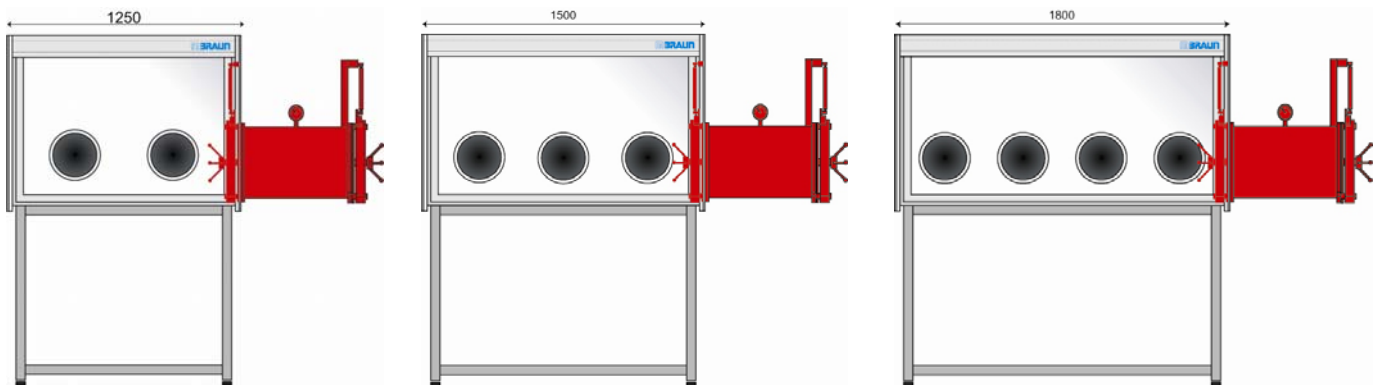

Dimensions

The MB MOD system is available in the following box depths: inside dimensions (mm)

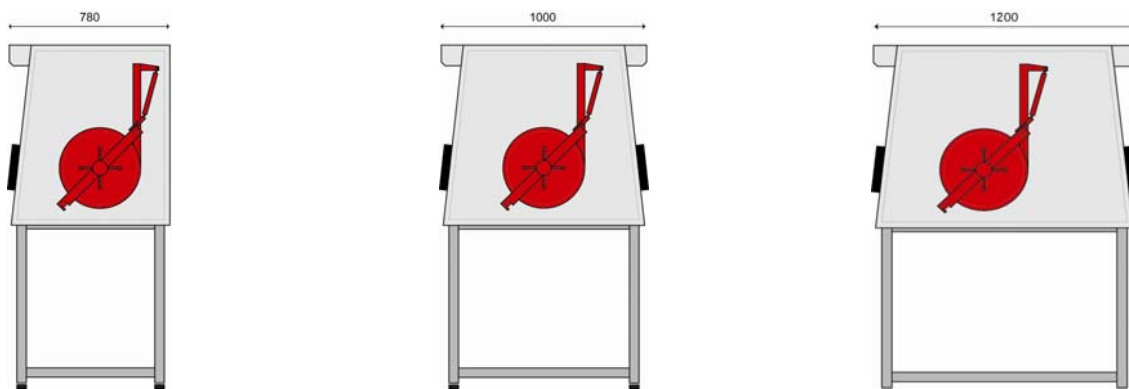

Box Volume Table

Box height 900 mm

Box length 1250 mm

Box length 1500 mm

Box length 1800 mm

Box depth 780 mm

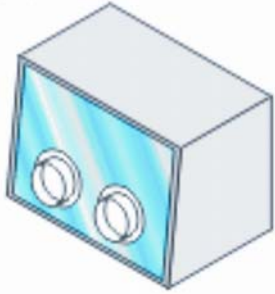

approx. 0.8 m³

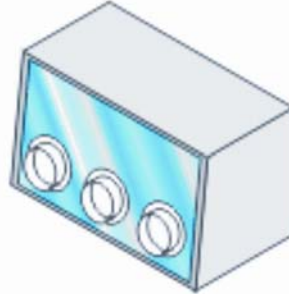

approx. 1.0 m³

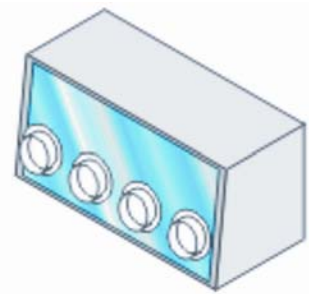

approx. 1.2 m³

Box depth 1000 mm

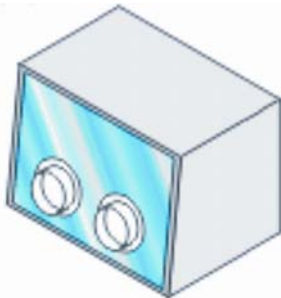

approx. 1.0 m³

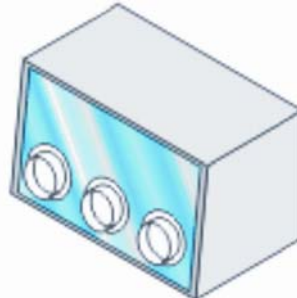

approx. 1.2 m³

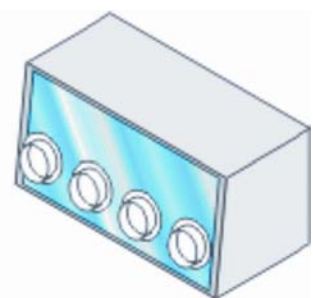

approx. 1.5 m³

Box depth 1200 mm

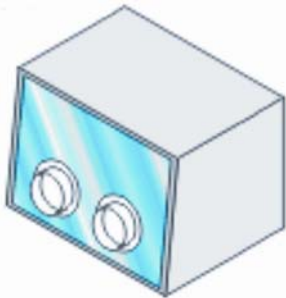

approx. 1.2 m³

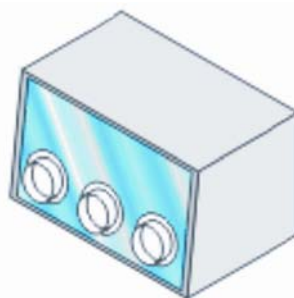

approx. 1.5 m³

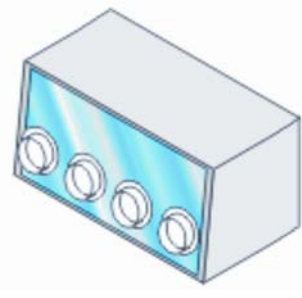

approx. 1.8 m³